

WREB
DENTAL HYGIENE and ANESTHESIA EXAM
Candidate Information

May 30, 31 and June 1, 2, 3, 4, 2012 Lane Community College Site

CLINIC INFORMATION & EQUIPMENT TYPE

The LCC Dental Clinic is located on the lower level of Building #4 in Room #108. It has an open floor plan with twelve ADEC dental units for candidates equipped with a minitrol over-the-client delivery system. Each unit also has a mobile cart. The operator can place a tray set-up on the minitrol or the mobile cart, according to the candidate's preference. A barrier wall divides the clinic from a 6 chair examiner area.

The sterilization area is adjacent to the clinical treatment area. Prior to the exam, expendable materials and supplies will be available in the sterilization or on an island in the clinic for candidates to set up their trays. After the examination, the sterilization room may be used by the candidates to disinfect equipment and sterilize instruments.

EXPENDABLE MATERIALS AND SUPPLIES

The following list of expendable materials and supplies will be available for use by all candidates:

Surface disinfect or disinfectant wipes	Plastic trays and tray covers
Face masks	Client protective lenses
Client napkins	2x2 gauze squares
Disposable napkin holders	Cotton swabs (long and short)
Plastic disposable barrier bags (various sizes)	Antimicrobial Mouthwash
Plastic disposable sticky squares	Soap
Standard saliva ejectors	Over gloves
Non-latex gloves	Paper towels
Disposable air/water syringe tips	Autoclave bags, tape and scissors
Available anesthetics include the following:	Topical anesthetic
<i>Lidocaine 2%, with epinephrine 1:100,000</i>	Drinking cups
<i>Mepivacaine 3%</i>	Facial tissue
<i>Bupivacaine 0.5%, with epinephrine 1:200,000</i>	Disposable prophy angles
<i>Septocaine 4% with epinephrine 1:100,000</i>	Prophy paste
Needles: 27-gauge long and 27-gauge short	View Boxes
Schwartz Perio Retriever	Topical anesthetic

Styrofoam Instrument Trays

Disposable trays are available for candidates to use during the check-in and check-out process. Large autoclave bags can be used for transport of used instruments from the examiner area to the clinician at the completion of the examiner evaluation.

PATIENT SCREENING: The clinic will be available for patient screening by out-of-town candidates from 5:30-7:30 p.m. the evenings before the clinical exam and after the clinic tour.

HANDPIECE AND PROPHY ANGLE HOOKUPS:

Handpieces: 4 hole Midwest Type back end configuration
Metal Prophy angles must be provided by the candidate. Disposable prophy angles are available. Handpieces are not available for rental.

SONIC/ULTRASONIC DEVICES:

All dental operatories will be equipped with **Dentsply 25k Bob-Cat ultrasonic units**. The candidate will be responsible for bringing **25k ultrasonic tips**. Ultrasonic tips are available for use the day of the examination. Candidates may bring their own scaling units. Adaptors are available for scaling units without a push-valve water connector.

X-RAYS: The LCC clinic can accommodate both digital and conventional radiographs. Exposure and developing is \$2.50 per film up to a maximum of \$25.00.

ANESTHESIA: Candidates should try to arrange their own clinician to administer anesthesia if one is needed. A practitioner will be on site to administer local anesthesia to candidates' patients if necessary. Please review the requirements for a clinician to administer anesthesia for your examination and prepare documentation for the Chief Examiner as required. Please notify LCC 541-463-5616 you need a clinician to administer anesthesia or notify the Chief Examiner as soon as possible the day of or day before the exam. LCC practitioners will only be able to provide administration for two candidates per testing session.

STERILIZATION PROTOCOL

Gloves, glasses and masks must be worn at all times during disinfecting and sterilizing procedures. A holding tank will be available for the placement of contaminated instruments that cannot be processed immediately. Instruments should be placed in metal or plastic cassettes for transport to the sterilization area and processed in the ultrasonic cleaner for ten minutes. Instrument cassettes should then be removed, rinsed, dried and placed in autoclave bags for sterilization. The WREB exam site coordinator will be available to assist candidates with the instrument recirculation and sterilization process. Identify pouches with your candidate number. The sterilization area will close at 7:30 p.m. each day of the examination.

INFECTION CONTROL PROTOCOL

Use of Barriers: Sticky squares and plastic disposable barriers of varying sizes are used to cover the following items and surfaces:

- Minitrol and tray--large plastic bag
- Operator chair adjustment arm--sticky square or small bag
- Light Switch--sticky square
- Light Handles—large piece of plastic wrap is used to encase the entire light and handle
- Unit mobile cart top--large bag
- Unit chair--large bag
- Evacuation arm and hose brackets--medium bag
- Evacuation hoses--small bag
- Low speed suction--small bag

Waste Disposal

Sharps disposal containers will be available close to the dental units used during the examination. After completion of examination procedures, the candidate should dispose of all sharps in the sharps container. The used tray set-up should be placed on the clinic counter marked "contaminated area". Contaminated bloody waste should be placed in the red contaminated-waste container located in the sterilization area. Disposable plastic barriers and other disposable waste should be placed in the other large waste containers.

Cleaning and Disinfection Procedures

Wearing clean gloves the candidate should remove the tray set-up from the "dental

operator contaminated area” and take the tray to the sterilization area for disinfection and sterilization procedures. Remove barriers and dispose in trash receptacle. Wearing clean gloves, the candidate should clean and disinfect the unit and working areas with an EPA registered tuberculocidal disinfectant provided, using 4x4 gauze squares and the saturate/wipe/saturate method. The suction lines are to be cleaned with enzymatic cleaner available at the sterilization room window.

The next candidate to use the unit, which has been disinfected, should re-bag/barrier the unit, adjacent working areas and equipment for his/her own use.

Setting up the Dental Unit and Treatment Area

The unit will be disinfected for you by a previous candidate. Gather the barriers you need and begin setting up your treatment area. You may wear exam gloves or clean hands with previously cleaned and disinfected items.

Place large barrier bags over the back of the chair; the cart and patient delivery system. The plastic barrier should hang over the front of the hose hangers on the delivery system. Use plastic wrap or sticky squares for light handles, light switch, and on operator stool handles. Use a medium barrier bag to cover the evacuation hose arm and hangers. Use barrier bags for evacuation and air/water syringe handpieces. Place saliva ejector and high speed evacuation items in hoses attachments and a disposable air/water tip in the handpieces if you are using them. Tape a plastic bag to the side of the tray holder. Place a large barrier bag on an adjacent counter surface for equipment and supplies used during the examination.

Blood Pressure Equipment is provided by the candidate.

EMERGENCY PROTOCOL

Portable oxygen tanks are located at both the east and west ends of the main clinic area. The emergency drug and first aid kit are located on the glassed-in desk at the entrance to the clinic. In case of emergency, the following protocol should be used:

1. Candidate remains with the patient and asks for assistance.
2. Another candidate or examiner calls 9-911 for emergency response.
3. Another candidate or examiner calls 5555 or 9-942-6455 for assistance from Campus Security. (Number is on the phone in the dental clinic)
4. Another candidate goes outside the Dental Clinic building to lead emergency responders to the location of the patient.
5. Oxygen is administered, if appropriate. (Bag, mask, valve, nasal canula, pocket mask)
6. CPR is administered, if appropriate
7. AED administered if appropriate. The AED unit is located on the east end of the south wall in the clinic. The AED unit is stored in a wall mounted, glass front cabinet.
8. Emergency treatment is administered, if appropriate, i.e. sweetened juice or glucose for insulin shock. A protein drink is also available for emergencies.
9. All other candidates leave the examination area with their patients until the emergency situation has ended.
10. The Schwartz Perio-Retriever is available in the Emergency kit at the glassed-in desk.

LCC DENTAL CLINIC LOCATION AND PARKING FACILITIES

The Dental Clinic is located on the lower level of Building #4 in Room #108. Candidates, patients and examiners should park in the Parking A or Parking B lots designated on the campus map. There are no reserved or designated parking spaces for dental clinic personnel, students or patients. There are handicapped spaces clearly marked in all parking lots. All parking is free.

FOOD AND LUNCH FACILITIES

There are vending machines in the Physical Education Building lobby (Building #5) adjacent to the Health Building (#4). Building #30 adjacent to the clinic is open 7am -5 pm weekdays for refreshments, pastries, sandwiches and salads. No dining facilities will be open on campus on Saturday or Sunday. North of the LCC campus, off I-5, there are many restaurants on Franklin Blvd.

AREA HOTELS/MOTELS

See maps included in packet

SECURITY

The Public Safety Office at Lane Community College is located in building #13, room 107. The office is staffed from 8 am - 7 pm Monday through Friday. Public Safety officers are on campus 24 hours a day, 7 days a week and can be reached by calling (541) 463-5558 during business hours. After hours, contact public safety at (541) 463-5555.

LCC MAIN CAMPUS LOCATION

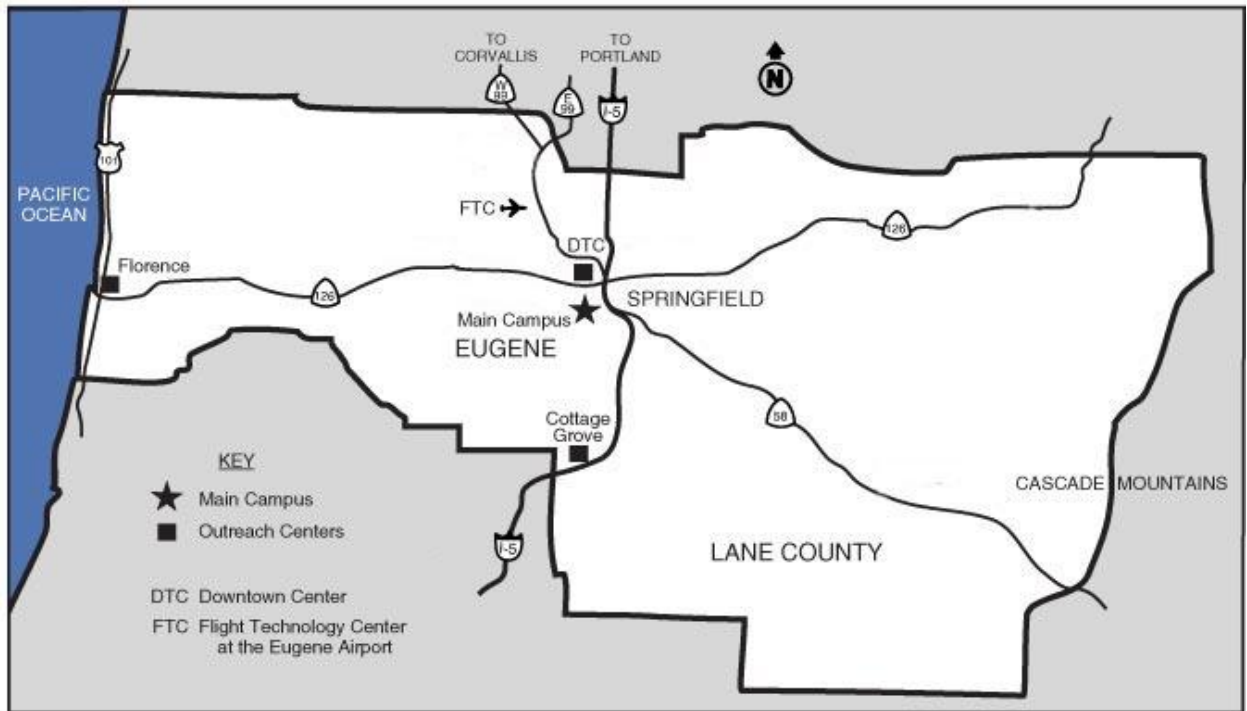

DIRECTIONS

NORTHBOUND (from the south) on Interstate 5. Take exit 189 and stop at the stop sign. Turn left and continue west to the first intersection. Go straight through the intersection and the next intersection and continue along 30th Avenue. Take the first exit to the right to access the west parking lots.

SOUTHBOUND (from the north) on Interstate 5. Take exit 189 and continue to the stop sign. Turn right at the stop sign and go straight until the next intersection with a light. Turn right at the intersection and go straight through the next intersection. Stay on 30th Avenue and take the first exit on the right to access the west parking lots.

Lane Community College Main Campus

4000 East 30th Avenue • Eugene, Oregon 97405 • (541) 463-3000

Map revised 09/2009

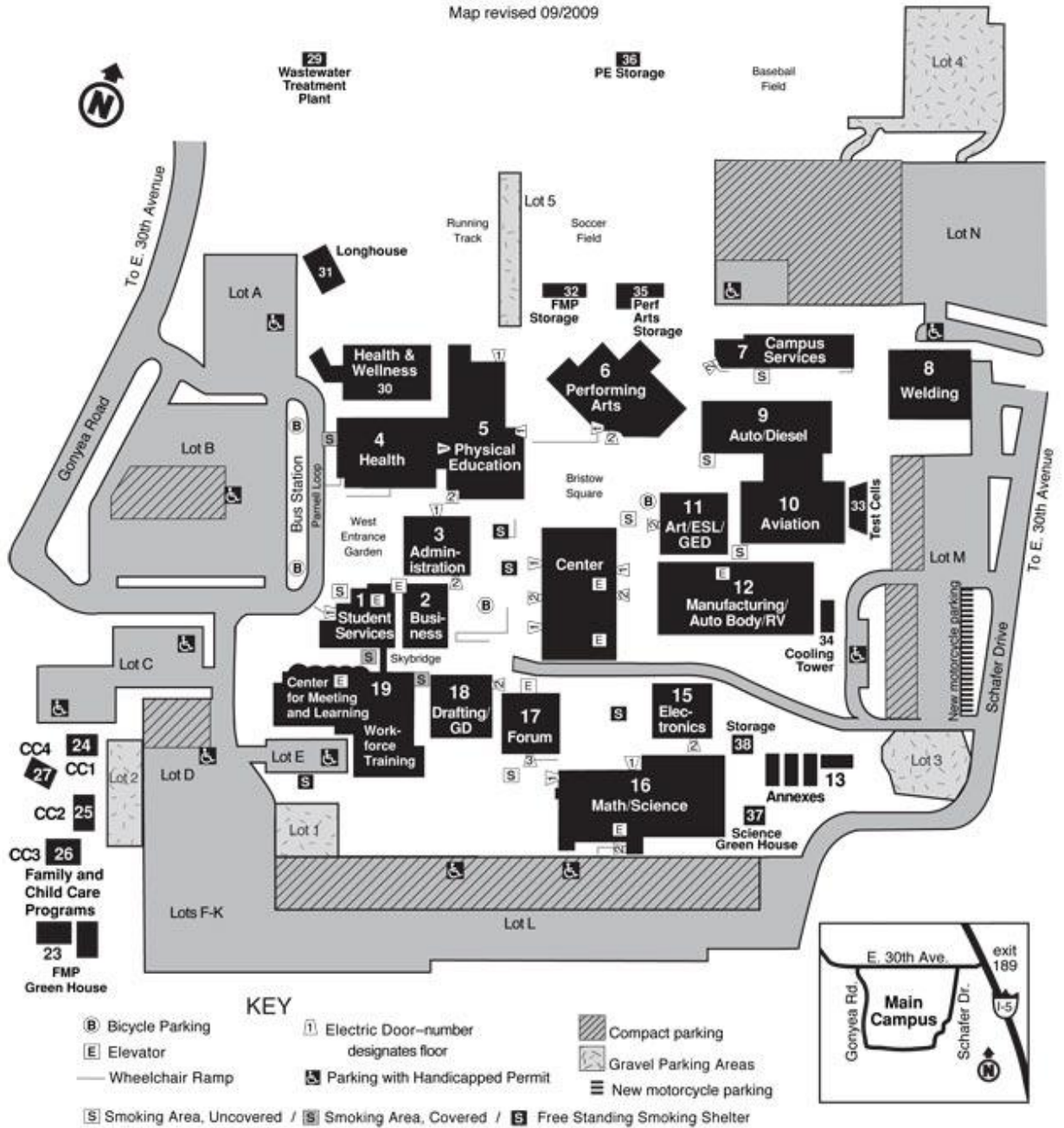

LCC CLINIC MAP

EAST

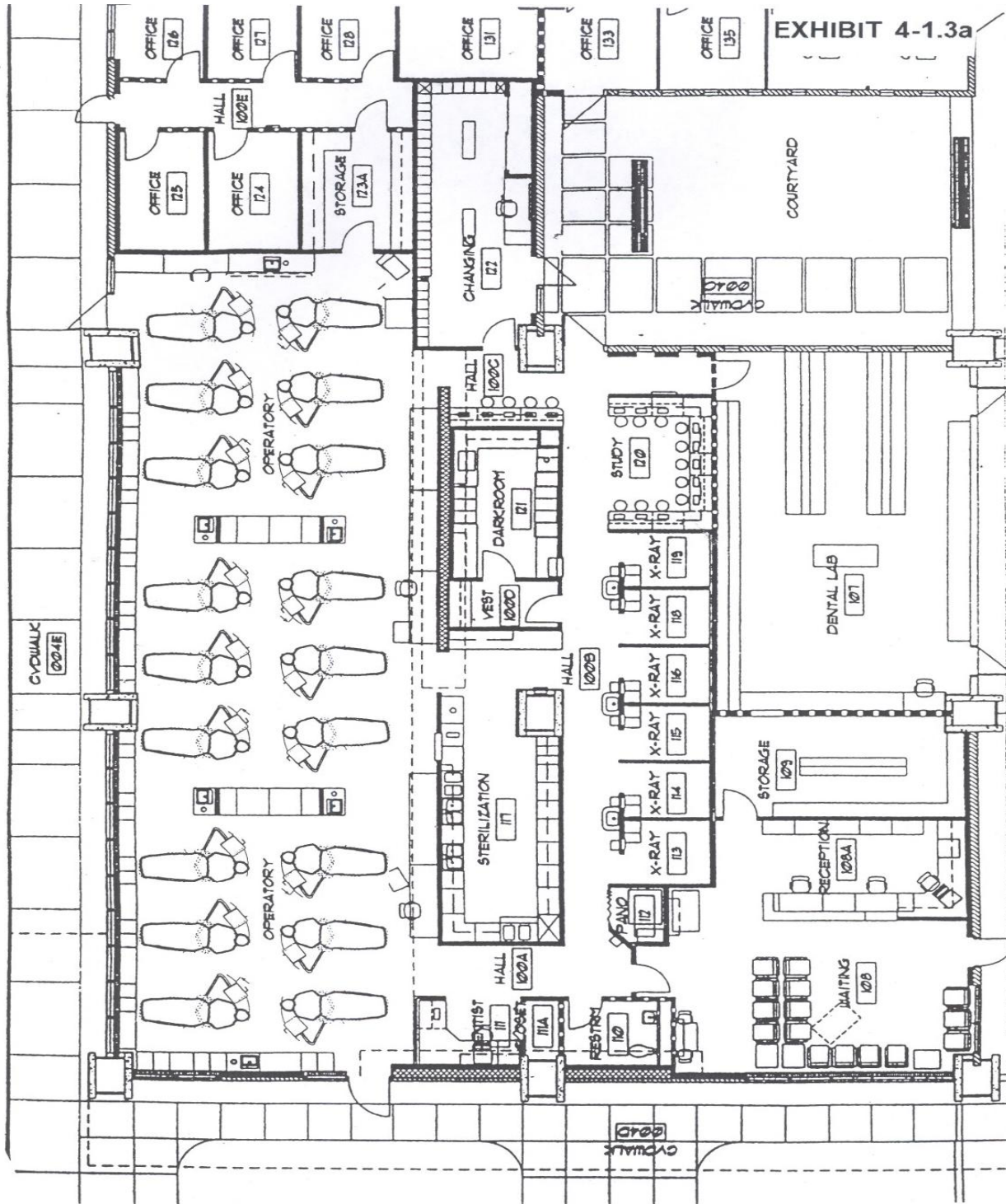

WEST

Oxygen Tanks are located along the south wall of the clinic at the east and west ends. The Medical Emergency Kit is located on the desk to the left of the main entrance to the clinic (from the waiting area). The AED is located on the wall in the southeast corner of the clinic. In case of emergency dial 9-911. To contact Security dial 5555 from campus phone or dial 541-463-5555

AREA HOTELS/MOTELS

Eugene

Phoenix Inn Suites 850 Franklin Boulevard, Eugene, OR 97403. Phone: 541-344-0001; Toll-free: 1-800-344-0131

Best Western Greentree Inn Franklin Boulevard, Eugene, OR 97403. Phone: 541-485-2727

Best Western New Oregon Motel 1655 Franklin Boulevard, Eugene, OR 97403. Phone: 541-683-3669

Campus Inn 390 E. Broadway, Eugene, OR 97401. Phone: 541-485-9392; Toll-free: 1-800-888-6313.

Motel 6 Eugene South 3690 Glenwood Drive, Eugene, OR 97403. Phone: 541-687-2395; Toll-free: 1-800-466-8356

Springfield

Super 8 Springfield/Eugene 3315 Gateway, Springfield, OR. Off I-5 exit 195 A/Beltline. Phone 541-746-1314

Shilo Inn 355 Gateway, Springfield, OR. Phone 541-747-0332

Quality Inn and Suites 355 Gateway, Springfield, OR. Phone 541-726-9266

WREB
RESTORATIVE EXAMINATION
Lane Community College
Exam Dates: May 30- June 4, 2012 and October 26-28, 2012

CLINIC INFORMATION & EQUIPMENT TYPE

The LCC Dental Clinic is located on the lower level of Building #4 in Room #108. It has an open floor plan with twelve ADEC dental units for candidates equipped with a minitrol over-the-client delivery system. Each unit also has a mobile cart. The operator can place a tray set-up on the minitrol or the mobile cart, according to the candidate's preference.

FACILITY PROTOCOL

PPE's: The candidate is required to wear a bring and wear a lab jacket and protective lenses.

The testing facility will open at 6:30 am and close at 7:30 p.m. each day of the examination.

FACILITY PROTOCOL

Setting up the Dental Unit and Treatment Area

Gather the barriers you need and begin setting up your treatment area. You may wear exam gloves or clean hands with previously cleaned and disinfected items. Place large barrier bags over the back of the chair; the cart; and the patient delivery system. Place high speed evacuation tip, disposable air/water syringe tip, and high speed and slow piece handpieces on unit.

Use of Barriers: *Plastic disposable barriers are used to cover the following items and surfaces:*

Minitrol and tray--large plastic bag

Unit mobile cart top--large bag

Unit chair--large bag

Waste Disposal

Amalgam waste is contained in a medium plastic bag attached to the typodont mount during the exam. Dispose of the amalgam waste in amalgam scrap container. Empty capsules in amalgam waste container then reclose/recap amalgam capsules and place in amalgam collection container provided for capsules at recirculation window.

Sharps disposal containers will be available close to the dental units used during the examination. Dispose of all sharps (burs, matrix band or broken instrument) in the sharps container. Notify the site coordinator if you need access to the reprocessing area (sterilization area). Dispose of amalgam contaminated supplies at the recirculation window. Other disposable waste should be placed in large waste containers and in-counter receptacles throughout the clinic.

Cleaning Up Procedures and Prep for next Candidate

Wearing PPE's remove and dispose of amalgam contaminated supplies and barriers. Remove bag attached to manikin pole and dispose of amalgam scrap in the scrap

amalgam container. The next candidate to use the unit will re-bag/barrier the unit, adjacent working areas and equipment for his/her own use.

MATERIALS AND SUPPLIES AVAILABLE

BIREX surface disinfect or disinfectant wipes	Paper towels
Instrument trays (plastic and disposable)	Dental Floss
Face masks	Cotton swabs
2x2 gauze squares	Small plastic dappen dishes
Disposable napkin holders	Amalgam Scrap containers
Plastic disposable barrier bags (various sizes)	Antimicrobial Mouthwash
Medium plastic bags for rod post amalgam scraps	Soap
Standard saliva ejectors	Cotton rolls
Non-latex gloves	Paper towels
Disposable air/water syringe tips	Autoclave bags
Drinking cups	Alcohol
Disposable prophyl angles	High Volume Evacuator
Rod posts for dentiform at each unit	Amalgam waste container

RESTORATIVE EQUIPMENT

8 Amalgamators will be located throughout the dental facility on counters and islands for easy access by candidates. Curing lights will be available at each dental unit. After the clinic tour there will be time for candidates to test operation of amalgamators and handpieces. Handpieces should be brought to the examination by candidates. Please see handpiece information below.

A limited number of Slow and Highspeed Handpieces will be available during the examination for use by candidates. **Lane recommends candidates bring their own equipment that they are familiar with to the examination.** Please notify the Chief examiner or LCC School Coordinator (541-463-5279) if you will need to use a handpiece for the examination. Lane will not be responsible for loaned equipment malfunction during the examination.

The two clinic islands will have disposable supplies. Designated containers for disposal of scrap amalgam and contaminated waste are at the recirculation window.

A cart will be located at each dental unit for equipment and supplies. The dental unit over the patient delivery system can accommodate a tray set-up for instruments. All dental units accommodate left and right handed clinicians. Each dental unit has two electrical plugs located on the dental unit base. The candidate may bring their own amalgamator and/or curing light.

HANDPIECE AND PROPHY ANGLE HOOKUPS

Handpiece connections are 4 hole Midwest Type back end configuration for both slow and high speed handpieces. There are two handpiece hoses at each unit. It is recommended that all restorative candidates bring their highspeed and low speed handpieces with them to the orientation and tour the day before the exam to verify they have the correct components.

Metal prophy angles and contra angles must be provided by the candidate.

EMERGENCY PROTOCOL

Portable oxygen tanks are located at both the east and west ends of the main clinic area. The emergency drug and first aid kit are located on the glassed-in desk at the entrance to the clinic.

In case of emergency, the following protocol should be used:

1. Candidate remains with the patient and asks for assistance.
2. Another candidate or examiner calls 9-911 for emergency response.
3. Another candidate or examiner calls 5555 or 9-942-6455 for assistance from Campus Security.
4. Another candidate goes outside the Dental Clinic building to lead emergency responders to the location of the patient.
5. Oxygen is administered, if appropriate. (Bag, mask, valve, nasal canula, pocket mask)
6. CPR is administered, if appropriate
7. AED administered if appropriate. The AED unit is located on the east end of the south wall in the clinic. The AED unit is stored in a wall mounted, glass front cabinet.
8. Emergency treatment is administered, if appropriate, i.e. sweetened juice or glucose for insulin shock. A protein drink is also available for emergencies.
9. All other candidates leave the examination area until the emergency situation has ended.

LCC DENTAL CLINIC LOCATION AND PARKING FACILITIES

The Dental Clinic is located on the lower level of Building #4 in Room #108. Candidates, patients and examiners should park in the Parking A or Parking B lots designated on the campus map. There are no reserved or designated parking spaces for dental clinic personnel, students or patients. There are handicapped spaces clearly marked in all parking lots. All parking is free.

FOOD AND LUNCH FACILITIES

There are vending machines in the Physical Education Building lobby (Building #5) adjacent to the Health Building (#4). Weekdays food services, cafeteria style, are available in the Center Building. The Health and Wellness building #30 next to the dental clinic has a snack counter with a variety of sandwiches and salads available. No dining facilities will be open on campus on Saturday or Sunday. North of the LCC campus, off I-5, there are many restaurants on Franklin Blvd.

AREA HOTELS/MOTELS

See maps included in packet

SECURITY

The Public Safety Office at Lane Community College is located in building #13, room 107. The office is staffed from 8 am - 7 pm Monday through Friday. Public Safety officers are on campus 24 hours a day, 7 days a week and can be reached by calling (541) 463-5558 during business hours. After hours, contact public safety at (541) 463-5555.

LCC MAIN CAMPUS LOCATION

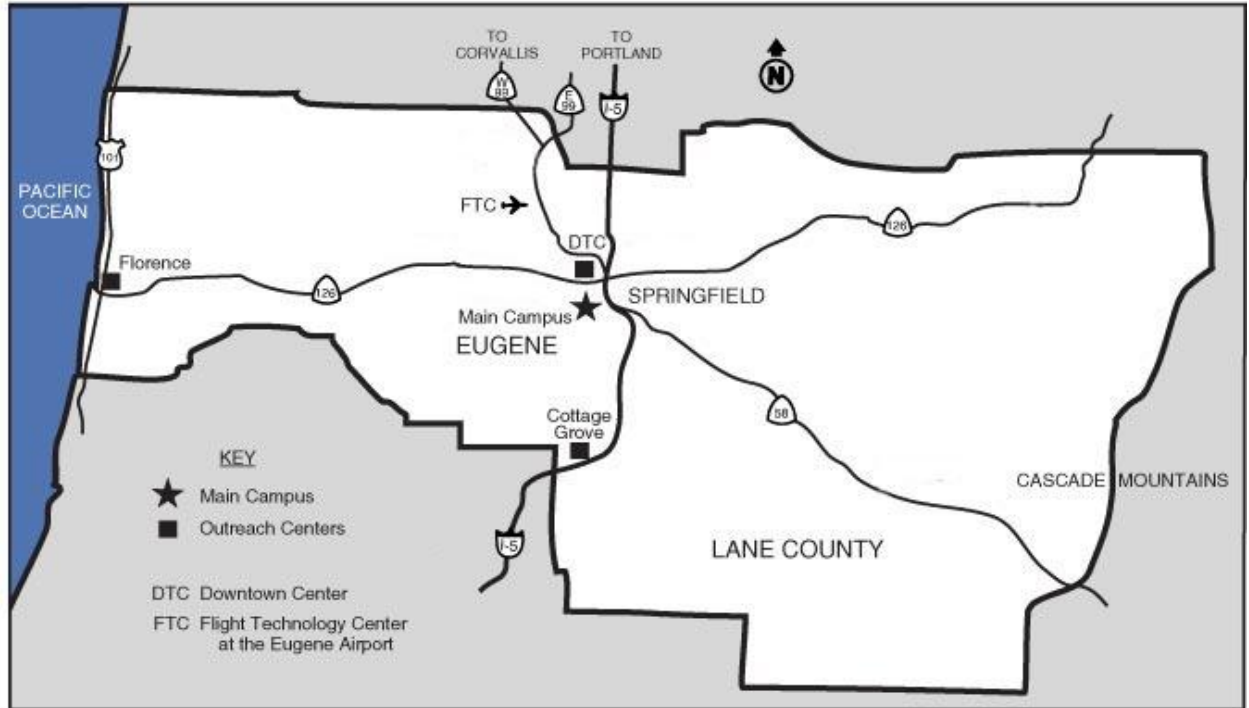

DIRECTIONS

NORTHBOUND (from the south) on Interstate 5. Take exit 189 and stop at the stop sign. Turn left and continue west to the first intersection. Go straight through the intersection and the next intersection and continue along 30th Avenue. Take the first exit to the right to access the west parking lots.

SOUTHBOUND (from the north) on Interstate 5. Take exit 189 and continue to the stop sign. Turn right at the stop sign and go straight until the next intersection with a light. Turn right at the intersection and go straight through the next intersection. Stay on 30th Avenue and take the first exit on the right to access the west parking lots.

Lane Community College Main Campus

4000 East 30th Avenue • Eugene, Oregon 97405 • (541) 463-3000

Map revised 09/2009

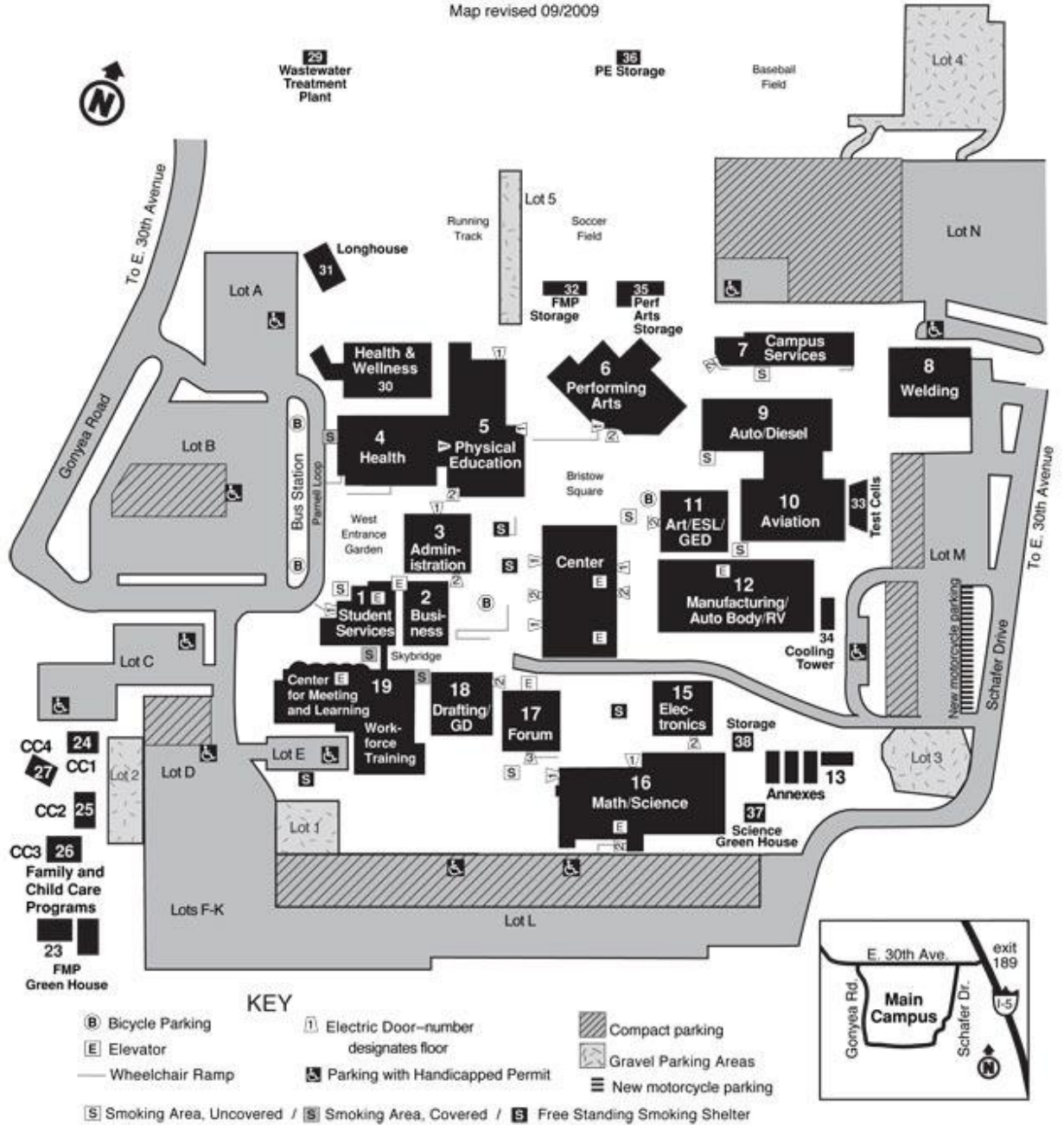

LCC CLINIC MAP

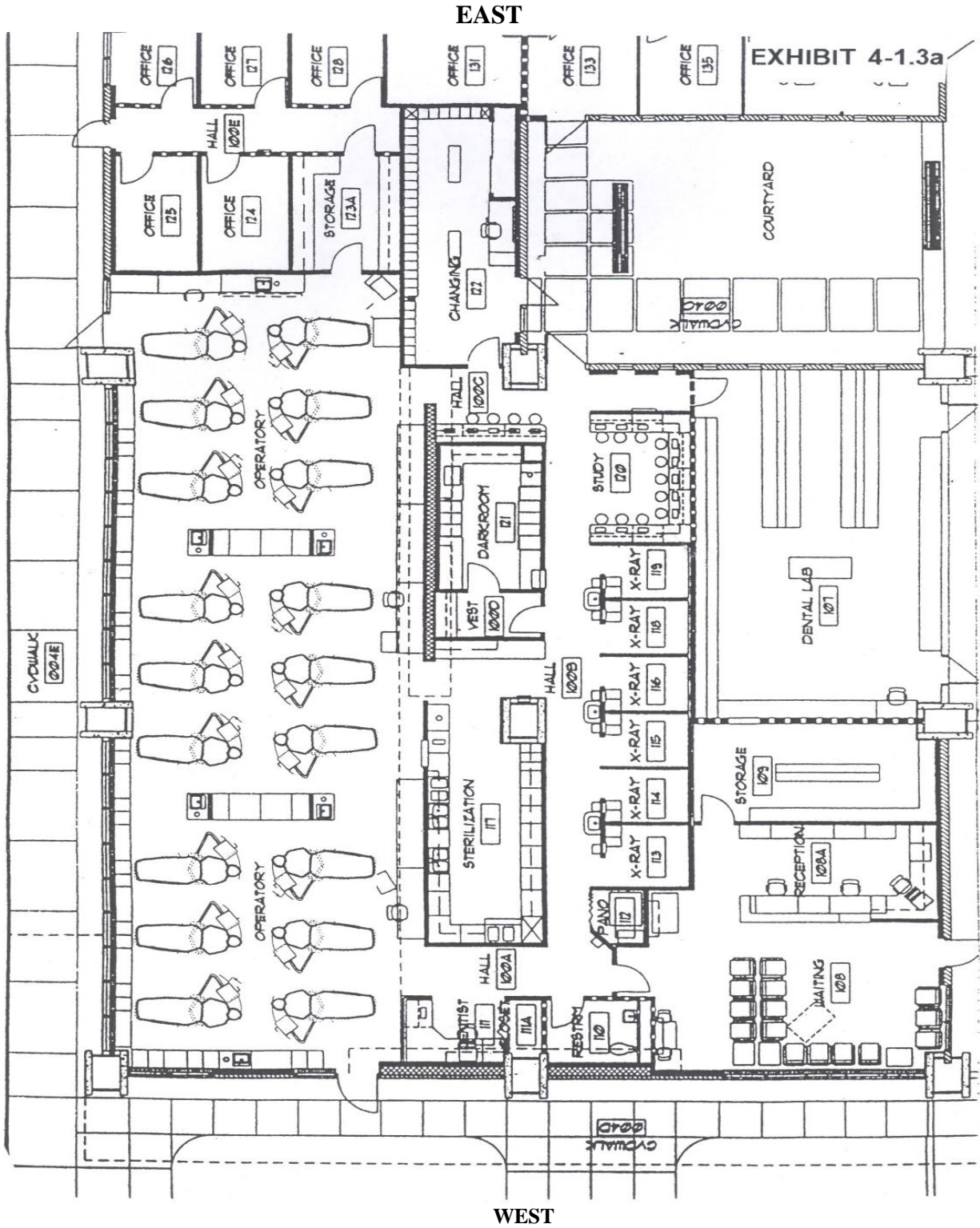

Oxygen Tanks are located along the south wall of the clinic at the east and west ends. The Medical Emergency Kit is located on the desk to the left of the main entrance to the clinic (from the waiting area). The AED is located on the wall in the southeast corner of the clinic. In case of emergency dial 9-911. To contact Security dial 5555 from campus phone or dial 541-463-5555

AREA HOTELS/MOTELS

Eugene

Phoenix Inn Suites 850 Franklin Boulevard, Eugene, OR 97403. Phone: 541-344-0001; Toll-free: 1-800-344-0131

Best Western Greentree Inn Franklin Boulevard, Eugene, OR 97403. Phone: 541-485-2727

Best Western New Oregon Motel 1655 Franklin Boulevard, Eugene, OR 97403. Phone: 541-683-3669

Campus Inn 390 E. Broadway, Eugene, OR 97401. Phone: 541-485-9392; Toll-free: 1-800-888-6313.

Motel 6 Eugene South 3690 Glenwood Drive, Eugene, OR 97403. Phone: 541-687-2395; Toll-free: 1-800-466-8356

Springfield

Super 8 Springfield/Eugene 3315 Gateway, Springfield, OR. Off I-5 exit 195 A/Beltline. Phone 541-746-1314

Shilo Inn 355 Gateway, Springfield, OR. Phone 541-747-0332

Quality Inn and Suites 355 Gateway, Springfield, OR. Phone 541-726-9266