

**CREIGHTON UNIVERSITY
SCHOOL OF DENTISTRY
APRIL 12-15, 2012**

WESTERN REGIONAL EXAMINING BOARD

SCHOOL INFORMATION TO CANDIDATES

Patients:

Creighton University School of Dentistry cannot provide patients for candidates. Patient brokering (selling of patients) will not be tolerated under any circumstances within the school of dentistry or on the premises of The University. Violation of this rule will result in immediate removal from the university campus. Please do not ask anyone at the school for patients or patient records.

Patient Screening:

The Dental School does not have patients available for candidates to screen. Candidates who solicit patients from the surrounding area may bring patients to the Dental School for examinations and/or radiographs on Wednesday, April 11th from 9:00 A.M. to 11:00 P.M. and Thursday, April 12th from 1:00 P.M. to 3:00 P.M.

Radiographs

Radiographs of patients may be taken by candidates using their own film. Radiographic services will be available on Wednesday, April 11th and Thursday April 12th. It is strongly recommended that candidates have radiographs taken before arriving at Creighton Dental School. Film will be available for purchase from the cashier on Wednesday, Thursday, and during the exam. Radiographic services include conventional radiographs and automatic developing as well as digital radiography. If digital radiology is used the images will be printed for use during the exam and a fee of ten dollars per patient will be assessed.

Supplies:

The following supplies are provided to the candidates in a mobile cart, at clinic stations, at the dispensary (room 226F) or in room 222B. The mobile cart will be at the clinic cubicle and the other locations are within easy access on the main clinic floor. Cavicide disinfectant is at each clinical cubicle.

Clinic Supplies listed on next page

Cart

25 & 27 gauge long needles
30 gauge short needles
High volume evacuation tips
Saliva ejector tips
Floss
Air water syringe tips
Patient napkins
Patient napkin clips
Topical anesthetic
Tongue blades
Tray covers
Cotton tip applicators
Cotton rolls
2 x 2 gauze
Disposable prophylaxis angles
Prophylaxis paste
Dycal
Vitrabond
Acid Etch kit
 Etchant bond, microbrush, clear
 matrix strip
Concepsis
Matrix bands #1, #2
Finishing strips
Disposable dappen dishes
Articulating paper
Microbrushes
Earplugs masks

Clinic Floor Station

Styrofoam trays
Local anesthetic
Amalgam
Wedges
Masks: ear loop, tie on, cone
Mouth wash
Drinking cups
Headrest covers
(Impression material) high/low
viscosity, and putty
Integrity (temporary material)
Regisil bite registration

Dispensing (Rm 226F)

Rubber dam
Rubber dam napkins
Vaseline
Sterilization bags
Sterilization tape
Hemodent

Room 22B

Retraction cord/viscostat kit
Wedges
Soflex discs
Ho matrix Bands #1, #2
Clear Matrix strips

Dental Supply Store:

The school store is located in Room 123 on the northwest corner of the first floor. Instruments and supplies may be purchased by candidates. The store will be open from 8:00 a.m. until 4:00 p.m. on Tuesday, Wednesday, and Thursday prior to the exam and will be open 7:30 a.m. to 9:30 a.m. during the exam.

Endodontic

The endodontic examination will be held in room 222. The laboratory will be equipped with manikin assemblies and typodonts. Facial shrouds will not be used for the manikin endodontic examination. The endodontic modules will be attached to the typodont base mount with a screw mount. Hand developing boxes and four portable radiographic units will be available in the endodontic lab. The school will supply gutta percha (.02ISO size and MF accessory cones), paper points, and AH plus sealer, irrigating solutions (sodium hypochlorite and water), and irrigating syringes (23 gauge side vented irrigating needle). High speed fiberoptic hand pieces will be available in the endodontic lab. The candidate is expected to furnish their own rotary instrumentation and/or files. The endodontic modules may be purchased from Aacadental products. Their address is Aacadental,

5830 Woodson, Suite 3, Mission, KS 66202. The Accidental typodonts , supplied by the school, will accept magnetic mounted segmented modules.

Casting Laboratory

The casting laboratory is located in room 359 and will be open from 5:00 p.m. until 10:00 p.m. Friday and Saturday evening during the exam. There are four casting wells and ten burnout ovens. Gold may be purchased from the cashier prior to the exam, however candidates who will be performing an indirect procedure are **STRONGLY ENCOURAGED** to purchase their gold prior to arriving at the testing site.

Dental Units:

Dental units on the clinic floor are **ADEC** units and are supplied with high volume suction, high speed 6 pin female connectors with an attached quick connect swivel adaptor for STAR high speed hand pieces. The slow speed is a standard four hole MIDWEST connection with an attached quick connect swivel adaptor for STAR slow speed hand pieces. Hand pieces are available for rent. All dental units have quick connect water sources for ultrasonic scaler use.

Equipment Rental:

Dental instruments and equipment will be available for rental. All rental equipment is the property of Creighton University. It is imperative that candidates needing to rent equipment must rent it prior to the exam. **If equipment rental is anticipated you must complete the enclosed form two weeks prior to the exam** and return it to Dawn Connor c/o Creighton University, School of Dentistry, 2800 California Plaza, Omaha, NE 68178. Equipment rental payment will be collected in the Dental Store (room 123). Upon payment for equipment, a voucher will be issued for the items rented. These items will be available from the dispensing room (226F) on the days of the exam. **There will be no equipment rental during the exam.** Payment for equipment is due upon voucher pick up and must be cash or certified check. (credit or debit cards are not acceptable) If you have questions concerning rental you may contact Ms. Dawn Connor at (402-280-5037). **Burs, endodontic instruments, and periodontal instruments are not included in the instrument rental.** Candidates are required to bring any equipment not listed in the rubber dam or operative kit list. The equipment contained in each kit is listed in the appendix with the candidate rental agreement.

Dental Unit Malfunctions:

Report unit malfunctions to the reception desk at the main clinic entrance. An equipment technician will come to your unit as soon as possible. Be sure to give the unit number (located on the face of the unit) to the receptionist.

Advertising:

Any candidate placing an advertisement for patients in the local media may not use the Creighton University name or logo or mention Creighton University in the advertisement.

Parking:

Candidates and patients may use the upper level of the parking garage located just west of the dental school. Access to this parking garage is from the south side. There is no fee for parking.

Request for information regarding school facilities or services, may be made to Dr. Dennis Higginbotham, (402) 280-4586 or Dr. Thomas Cavel, (402)280-5078.

AREA HOTELS AND MOTELS

Motel and hotel accommodations are numerous. These accommodations are close to the Creighton campus:

Doubletree Hotel 1616 Dodge Street 402-346-7600	Radisson Redick 1504 Harney 402-342-1500	Hilton Omaha 1001 Cass St. 402-998-3400
Best Western Seville Plaza Hotel (Within walking distance) 3001 Chicago 402-345-1963	Embassy Suites Hotel 555 So. 10 th 402-346-9000	
Hilton Garden Inn 1005 Dodge 402-341-4400	Courtyard by Marriott 9 th and Dodge 402-397-6500	
Hampton Inn 1212 Cumming St. 402-345-5500	Homewood Suites 1314 Cumming St. 402- 345-5100	

The following is a telephone directory listing of area dental laboratories.

AAA Dental	553-8846	Midlands Dental Lab	334-6701
Ace Dental Studio	331-6277	Plate Works Dental	933-4324
Apex Dental lab	614-6751	Poole Enterprises	884-1849
Bennington Crown and Bridge	238-2909	ProviDent Lab	399-1739
Billings Dental Lab	551-5954	Quality Dental Arts	614-7000
Ceramic Dental Studio	330-5676	Reliable Dental Inc.	334-0274
Colwell Dental	734-1083	Ski's Dental Design	292-5418
Custom Dental Lab	551-8352	Smith Dental Lab	339-8419
Dentistic Services	445-0688	Snow Dental Lab	493-2668
Jodanco	597-8884	Standard Dental Lab	393-4302
Kiess Kraft Dental Lab	391-8424	Watson Dental Lab	330-7865
Larson Dental Lab	571-7701	West Omaha Restorative	493-3605

It is the responsibility of the candidate to contact one of these laboratories prior to the exam date to verify that they will be able to meet the needs of the candidate and the time frame imposed by the exam schedule. The main clinic waiting area located on the second floor is the best location for pick up and delivery of laboratory cases.

POTENTIAL PATIENT LOCATION IDEAS

University of Nebraska, Omaha
60th and Dodge
Omaha, NE

University of Nebraska Medical Center
42nd and Dewey
Omaha, NE

College of St. Mary's
1901 S. 72nd Street
Omaha, NE

Metropolitan Technical Community College
Elkhorn Valley Campus
204 and West Dodge Road

Fort Omaha Campus
30th and Fort

South Omaha Campus
27th and Q Streets

Douglas County Social Service
Dental Health
4102 Woolworth
Omaha, NE

Eastern Nebraska Human Services Agency
885 s. 72nd Street
Omaha, NE

Offutt Air Base
Hwy, 73-75
Bellevue, NE

INFECTION CONTROL PROTOCOL

SURFACES ASEPSIS:

All counter tops, chair surfaces, and operatory fixtures should be wiped with disinfectant spray. The disinfectant spray bottles are available in the operatory units. Headrests and light handles should be covered with plastic wrap, available at clinical supply stations on the clinic floor.

WASTE DISPOSAL:

Hazardous waste consists of materials containing substances that are or have the potential to be detrimental to ones health or environment. Containers for disposal are available at each clinic supply station and so labeled.

Non-Hazardous wastes are disposed of using the receptacles located under each operatory sink.

Sharps must be disposed of in properly marked containers. These containers are located on the main clinic floor.

STERILIZATION PROCEDURES:

Candidates supplying their own instruments should follow this protocol:

- A. Instruments should be cleaned with soap and water and thoroughly dried.
- B. Sterilizing bags are available at the sterilization check-in window (Room 225).
- C. The candidates name and number should be placed on the sterilizing bag.
- D. All sterilizing bags should be turned into the sterilization check-in window (Room 225) for sterilization.
- E. Sterilization will begin at 7:30 A.M. and continue until 5:30 P.M. Each sterilizing cycle takes a minimum of 45 minutes. Instruments turned in after 5:30 P.M. will be sterilized the following morning and will be ready for use by 7:30 A.M. All sterilized instruments may be picked up in dispensing room 226F (see map).

EQUIPMENT RENTAL LIST

Operative Cassette

Slots from left to right

- Mirror
- 23 Explorer-Probe
- Spoon Excavator 38-39
- Hatchet 8-9
- Hoe 14-15
- Mesial Margin Trimmer 29
- Distal Margin Trimmer 28
- Small Condenser
- Large Condenser

- IPC
- ½ Hollenback
- Cleoid/discoid
- Walls Carver
- Composite Instrument
- Ball Burnisher
- Apple Seen Burnisher
- Cord Packing Instrument
- Curette/Scaler
- Cement Spatula
- Aspirating Syringe
- Cotton Pliers

Top Free Space

- Bard Parker Handle
- Dycal Applicator
- Matrix Band Retainer
- Articulating Ribbon Holder
- Amalgam Carrier
- Small Amalgam Well

Attached to Lid

- Crown and Collar Scissors
- Curved Kelly Hemostat

Rubber Dam Cassette

Large Free Space

- Rubber Dam Forceps
- Rubber Dam Frame
- Rubber Dam Punch

Small Free Spaces

- W00
- W2
- W3
- W4
- W7
- W8
- W9
- W212
- W14A
- W14DT

Medical Emergency Protocol

In the event of a medical emergency, please follow the clinic emergency protocol which is posted in several locations, including treatment operatories, throughout the clinic.

CLINIC EMERGENCY PROTOCOL

Assess responsiveness

If not responsive, activate EMS by calling Public Safety.

Extension **2911**

Identify yourself and state "WE HAVE A MEDICAL EMERGENCY AT THE DENTAL SCHOOL, 2802 WEBSTER PLAZA AND WE NEED A RESCUE SQUAD."

Provide the specific location: ie. main clinic 2nd floor, , etc. Indicate the nature of the problem, the sex, approximate age and condition of the patient.

Check Airway, Breathing, and Circulation as learned in

CPR Begin Basic Life Support.

Send personnel to retrieve Automated External Defibrillator (AED) located on the north wall of the clinic outside of the sterilization window (room225).

Monitor blood pressure, pulse, respiration.

Send someone to the main lobby to meet the emergency team.

Notify the chief examiner.

An AED emergency defibrillator is located outside room 225C on the main clinic.

A fully equipped "crash cart" will be located in the adult reception area during the exam.

Rental Agreement and Fee Schedule

I agree to be responsible for the items listed below. If the items are lost, missing or broken, I realize that my board results will be withheld until the items are replaced.

Name _____

Address _____

Phone Number _____

Candidate Number _____

Items Rented

___ Operative and rubber dam kits with fiberoptic
high speed and slow speed hand pieces \$300.00

___ High Speed Handpiece \$150.00

___ Slow Speed Handpiece \$95.00

___ Operative Instrument Kit Only \$95.00

___ Rubber Dam Kit Only \$35.00

Candidate Signature _____

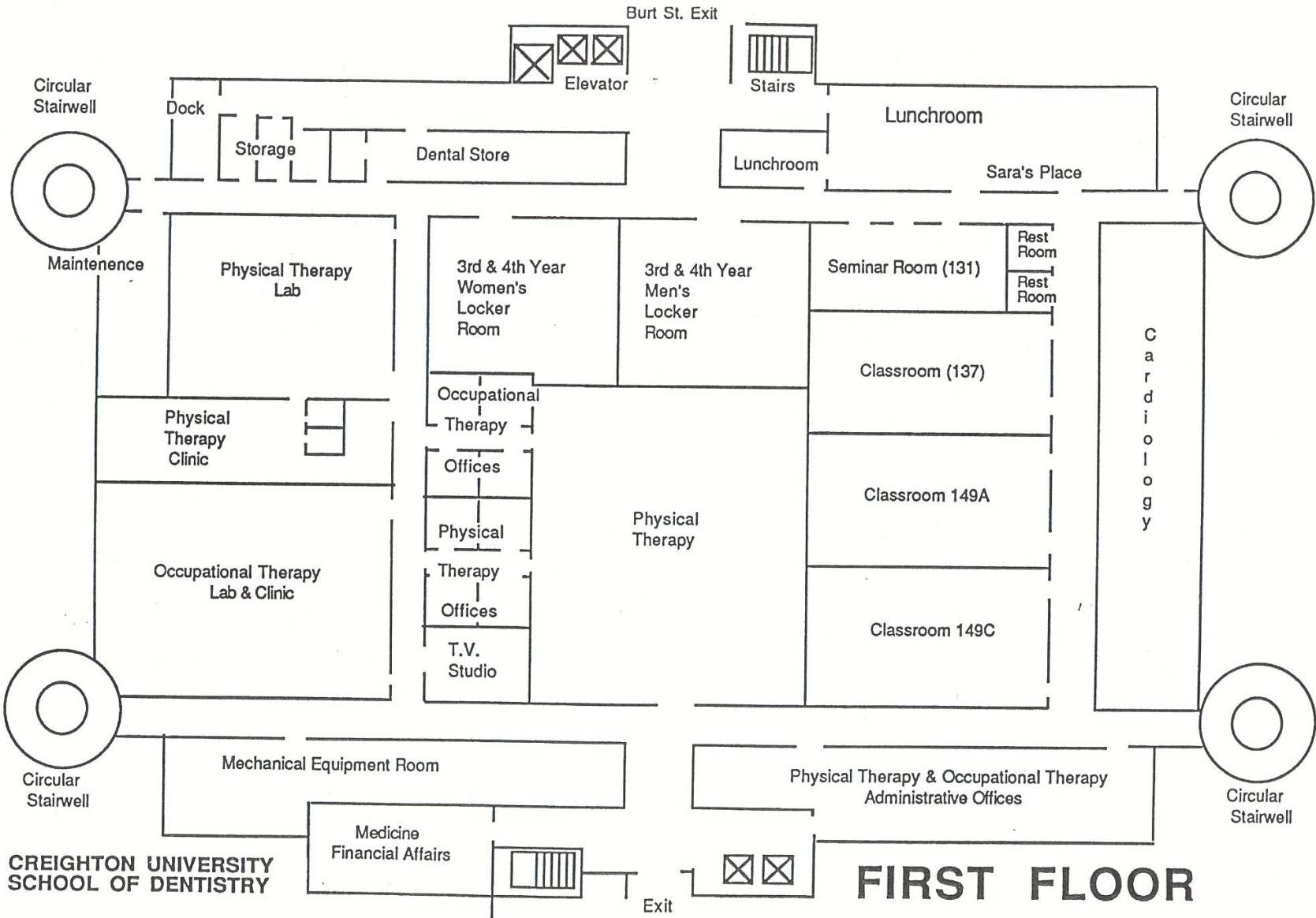

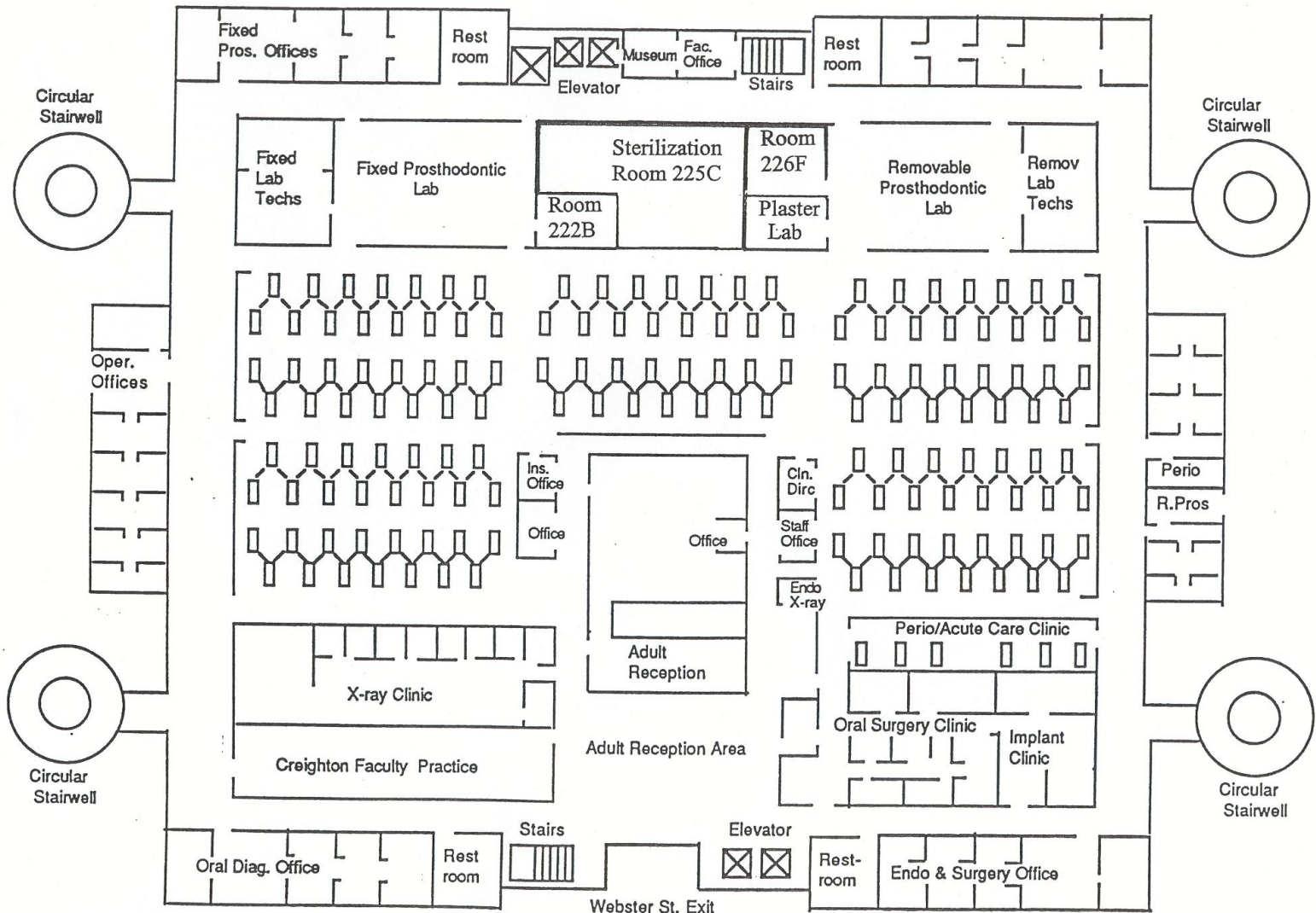

CREIGHTON UNIVERSITY
SCHOOL OF DENTISTRY

SECOND FLOOR

